

# SSD Pro44 Chassis Mounted Servo & V2 Conversion (305mm)

**Note:** The SCX10 chassis will need to be disassembled with the both axes and all links removed before starting.

**SCX10 II axes are needed to complete the conversion.**

## 1 Assemble the Panhard bar

**Note:** One long rod end is required to get the correct length for SCX10 II axes

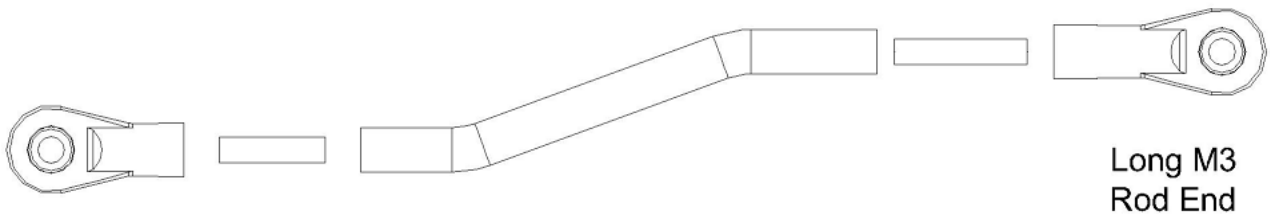

Short M3  
Rod End

Long M3  
Rod End

## 2 Assemble front upper link

Make 1



Short M3  
Rod End

80

## 3 Assemble front lower links

Make 2

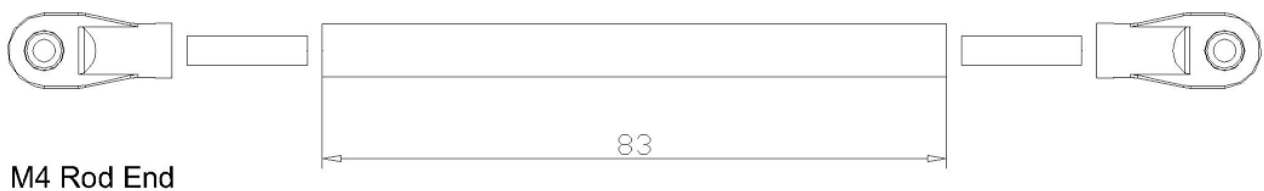

M4 Rod End

83

#### 4 Assemble the rear upper links

Make 2



#### 5 Assemble the rear lower links

Make 2

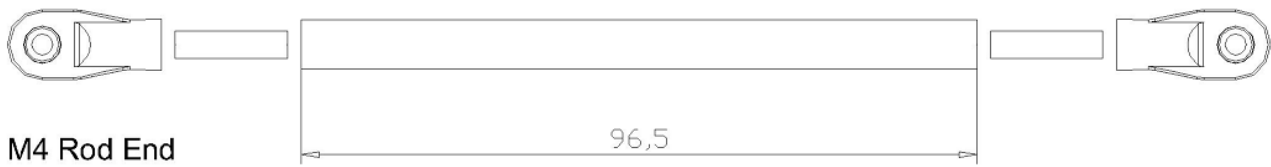

6 If you are using the stock plastic cross member then it will need to be cut.

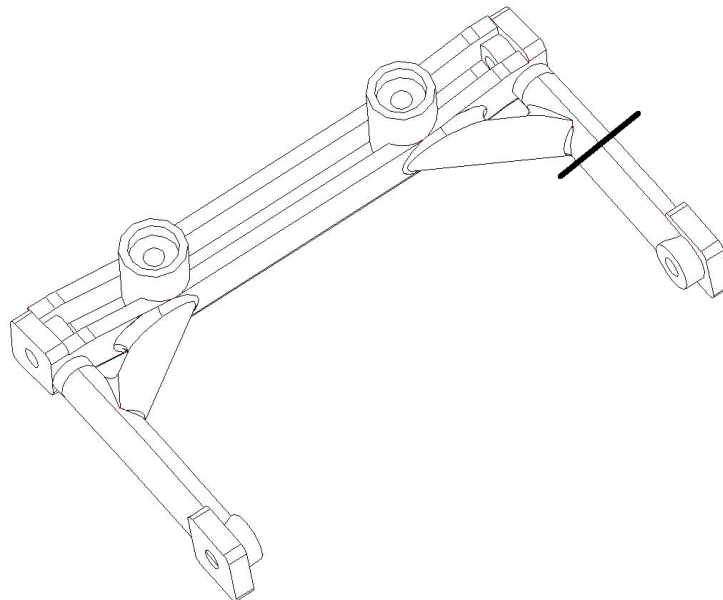

## 7 Fit the servo mount parts

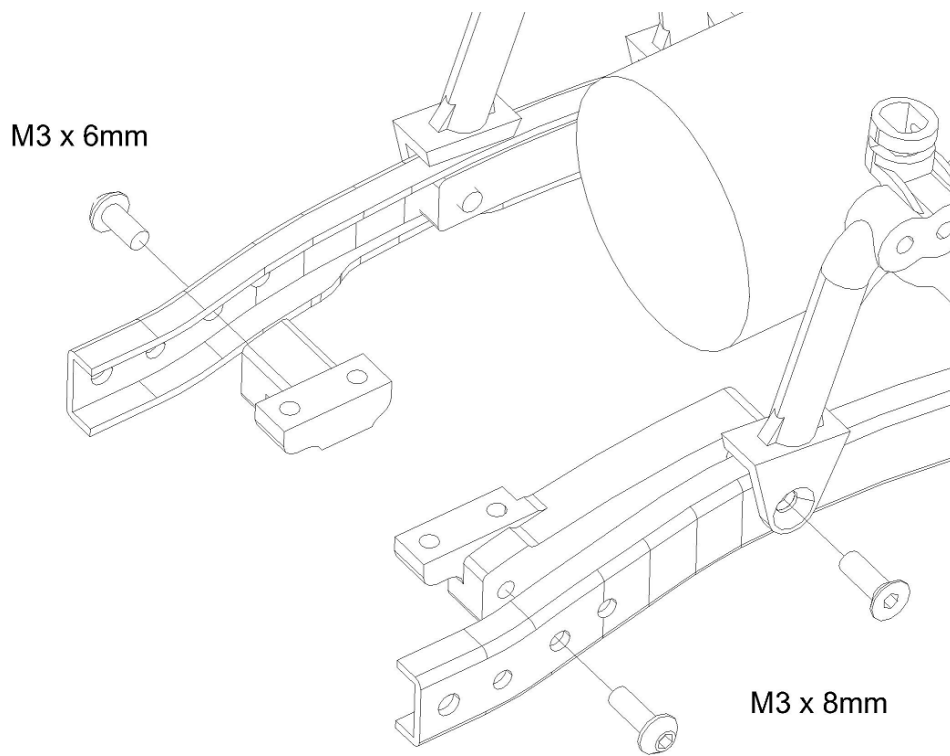

## 8 Fit the servo

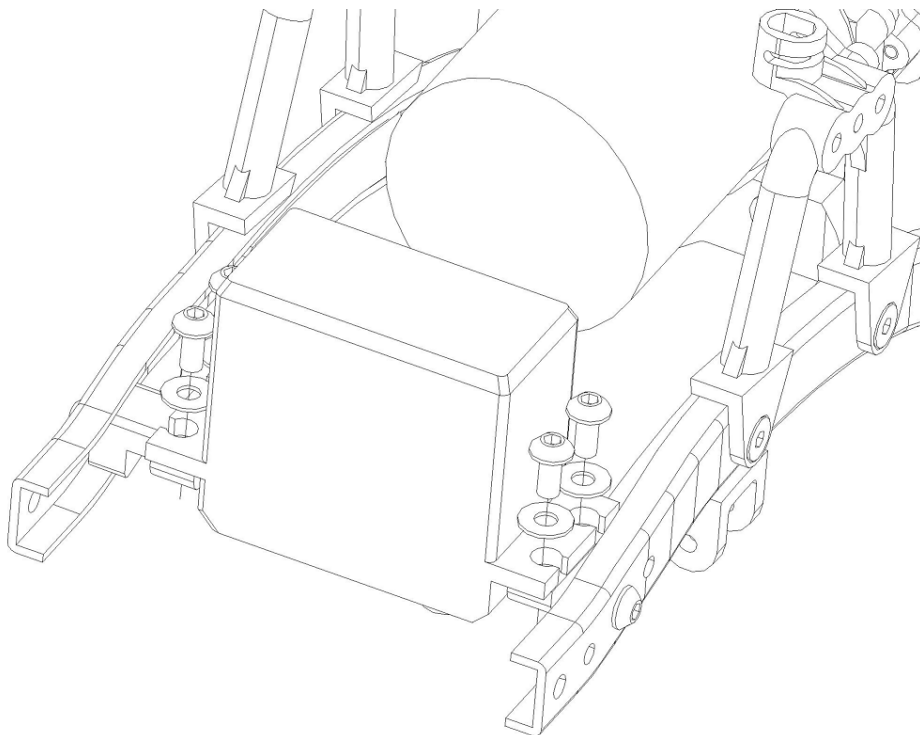

## 9 Move rear shock hoops back

The rear shock hoops need to be in the long wheelbase position (rear holes) even though the wheelbase is 305mm.

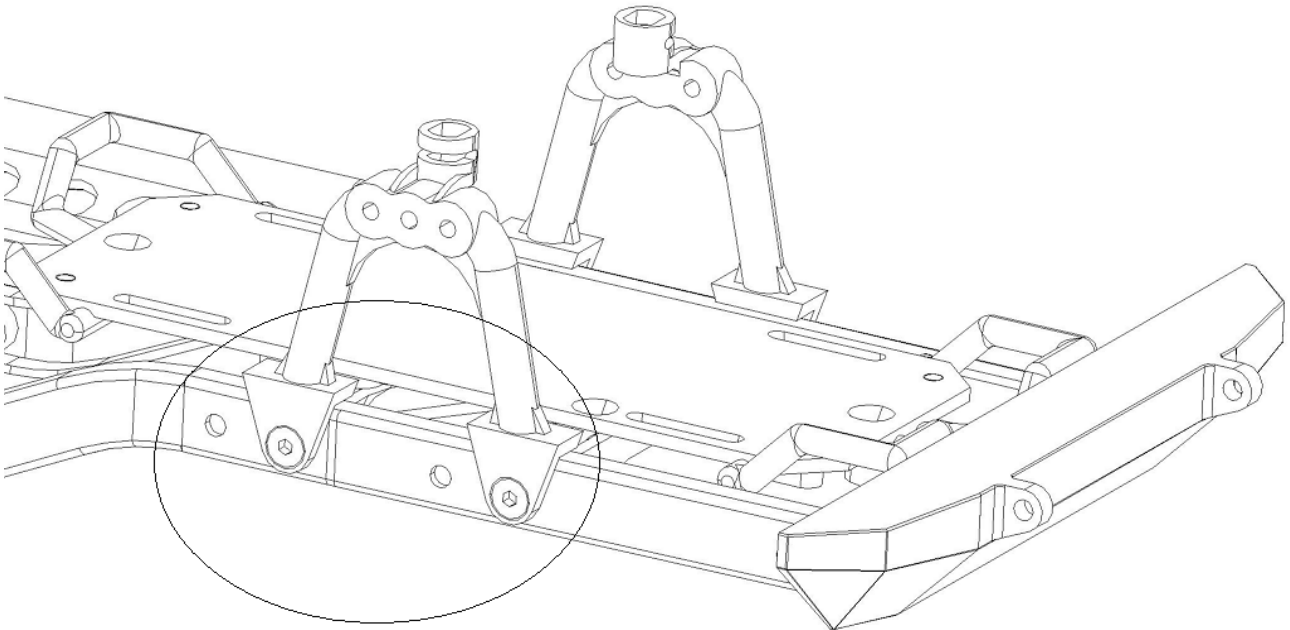

## 10 Install the new links and axles

The new suspension links can now be fitted to the chassis. The SCX10 II axles can then be installed. See SCX10 II assembly manual for details.

## Recommended Parts

- SSD00207 Pro44 Axle Case for SCX10 II
- SSD00209 Pro44 Rear Axle Case for SCX10 II
- SSD00212 Pro44 Titanium Steering Links for SCX10 II
- SSD00159 Aluminum Link Mounts for SCX10 II (Black)
- SSD00144 Pro Aluminum Knuckles for SCX10 II (Black)
- SSD00145 Pro Aluminum C Hubs for SCX10 II (Black)
- SSD00182 Knuckle Bushing Set for SCX10 II
- SSD00193 Super Heavy Brass Knuckles for SCX10 II / Pro44 Axle
- SSD00196 HD Steel Locker for SCX10 II / Pro44 Axle